



Wright Manufacturing, Inc.

Work Inst. Name: **Replaceable Clutch Stop**

Inst. Number: **SVC-SWI-0019**

Revision: 01

Issue Date: N/A

Author: Chris Sturtz

Date: 2/27/15

Reviewer: Chris Sturtz

Date: 2/27/15

Approver: Chris Sturtz

Date: 2/27/15

Related Documents: SVC-PB-0010

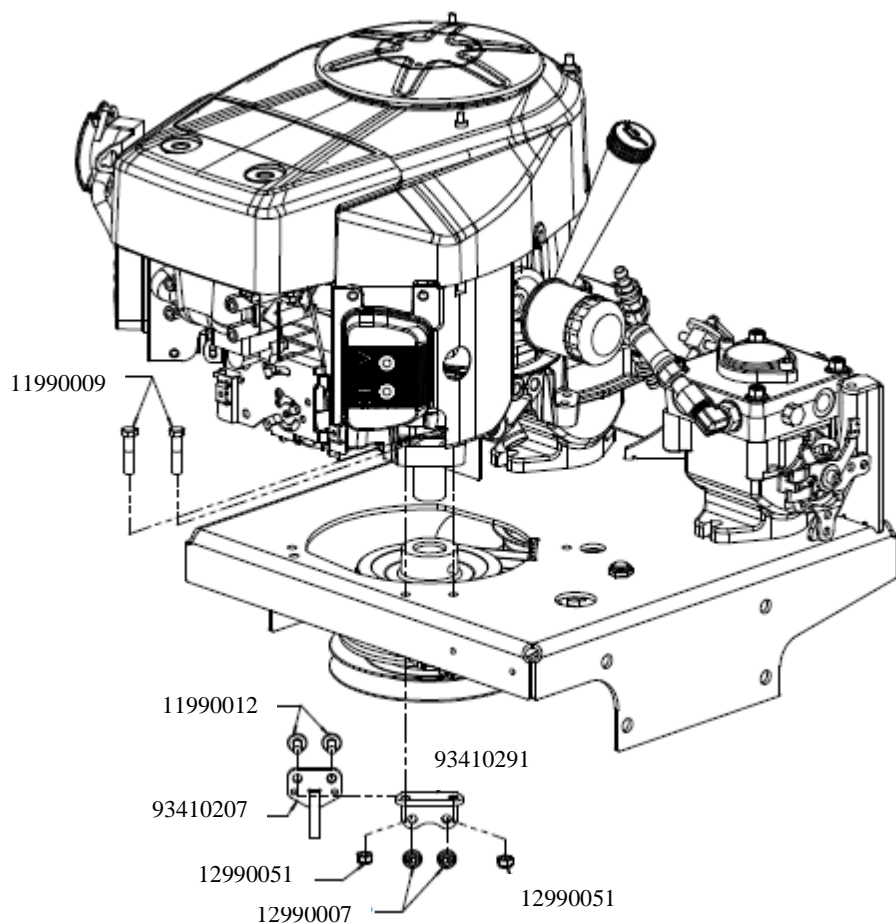

New bolt in clutch stop moves to the forward engine bolt mounting location and utilizes the second stop location on the clutch bell housing. Orientation of the clutch bell housing stays the same.



Revision Table

Name	Date	Reason for Changes	Version
Ed Wright	N/A	Initial Release	00
Chris Sturtz	2/27/15	Format Update	01