



Operator's Manual



WRIGHT DUAL WHEEL KITS

For the following kits:

- 95410045 – Dual Wheel Kit, Pro Tech, WSZK 72
- 95410048 – Dual Tweel Kit WSZK 72
- 95410050 – Dual Tweel Kit WZXT 72
- 95410051 – Dual Wheel Kit WZXT 72
- 95410052 - Tweel Flip Kit ZK 52
- 95410067 - Dual Wheel Kit, Carlstar, WSZK 72

Revised 01/10/25

FAILURE TO FOLLOW SAFE OPERATING PRACTICES MAY RESULT IN SERIOUS INJURY OR DEATH.

Read this manual and other manuals that came with your mower before operating.

©1998-2025 Wright Manufacturing, Inc. All rights reserved. This material may not be reproduced or copied, in whole or part, without written permission from Wright Manufacturing, Inc. Grass Gobbler, Gobbler, Leaf Gobbler, Velke, Pro 1, X2, Stander, and Sentar are trademarks of Wright Manufacturing.

Thank you for choosing to purchase our equipment. We are focused on giving you advanced engineering and quality construction in each machine we build. This manual explains the features and promotes safer use of the machine. Please read it in its entirety and follow the instructions carefully so that you can have many years of safe and productive operation with your Wright machine.

Your Wright dealer knows your machine and is interested in your satisfaction. Your dealer can provide you with quality maintenance and other assistance that you may need.

This manual is an important part of your machine and should remain with the machine when you sell it.

The owner's responsibilities include, but are not limited to, ensuring operators and mechanics read and understand this manual, adhere to its recommendations and procedures for safe operation, and maintain the machine for safe operation. The owner must not make assumptions as to the qualification of operators or permit careless or unqualified operators to have access to this machine. Wright reserves the option to make changes at any time without notice.

CAUTION

Accident prevention regulations, other general safety regulations, occupational safety rules, and traffic regulations must be followed without fail.

The optional dual wheel kit for the Stander ZK is provided for the purpose increasing the performance of the machine for specialty work, including slope operation up to 30 degrees. As such, proper operator training and site evaluation is critical when operating this accessory.

- Before operating on slopes, walk the area and evaluate the surface for traction and smoothness. Slopes with drop offs, water, or compromised traction should be maintained through other maintenance techniques.
- Slow down and use extra care on hillsides. Be sure to travel in the recommended direction on hillsides. Turf conditions can affect the stability of the machine.
- Do not operate near drop-offs, ditches, embankments, or water. The machine could suddenly roll over if a wheel goes over the edge or the edge caves in. The machine could suddenly slide if traction is compromised. Leave a safety area between the machine and any hazard.
- Slow down and use caution when making turns and when changing directions on slopes.
- Slopes are a major factor related to accidents. Operation on all slopes requires extra caution.
- Establish your own special operating procedures and rules for operating on slopes. These procedures must include a survey of all mowing sites to determine which slopes are acceptable. Always use caution, and good judgement when performing this survey.
- Note that high traction conditions present a greater rollover hazard while lower traction conditions present a greater loss of control hazard. Ground and turf conditions vary depending on the weather and must be taken into consideration at all times.
- Some liquid landscape chemicals contain surfactants which may be very slippery and severely compromise safe operation.
- Do not operate on steep slopes or slopes exceeding 30 degrees.
- Do not operate the machine on slopes when the grass is wet.
- Do not operate machine under any condition where traction, steering, or stability is in question. Tires could slide even if the wheels are stopped.
- Always keep the machine in gear when going down slopes. Do not coast downhill.
- Avoid starting and stopping on slopes. Avoid making sudden changes in speed or direction. Make turns slowly and gradually.
- Use extra care while operating machine with a grass catcher or other attachment(s). They can affect the stability of the machine.
- There is a danger of suddenly sliding sideways or down the hill. When operating on a slope, travel across the grade whenever possible, not in an up or down pattern.
- Reduce speed and exercise extreme caution on slopes and in sharp turns to prevent tipping or loss of control. Be especially cautious when changing direction on slopes.
- Do not operate tires that are worn beyond 3/32" of tread. Do not use unapproved treads or tire pressures. Unapproved treads or excessive pressures can compromise your traction.

Installation Instructions - WSZK 72 Pro Tech Kit (95410045)

1. Use 1/2" wrenches to remove anti scalp assemblies from outside rear corners of cutter deck.
2. Use a 13/16" socket to remove tire from mower, keep lug nuts (12990082) for reuse.
3. Use a 3/4" socket to attach wheel drum (91410450) to inner wheel assembly with the provided nylock nuts (12990038).
4. Torque nuts to 80 ft-lbs.
5. Install valve extension to inner wheel assembly tire valve stem.
6. Route valve extension through hole in drum.
7. Use a 13/16" socket with extension to attach assembled wheel and drum to wheel motor hub by reaching through the access holes of the drum. Use the provided lug nuts (12990082).
8. Torque nuts to 80 ft-lbs.
9. Remove one (1) nut from valve extension and insert valve extension into the valve extension plate (91410486).
10. Use a 1/2" wrench to install nut onto valve extension and tighten extension onto plate.
11. Install valve extension plate onto the studs of the wheel drum.
12. Attach outer wheel to wheel drum, re-using the original lug nuts (12990082).
13. Use a 13/16" socket and torque nuts to 80 ft-lbs.

After install, check lug nut torque every 100 hours to ensure the safety and performance of your machine.

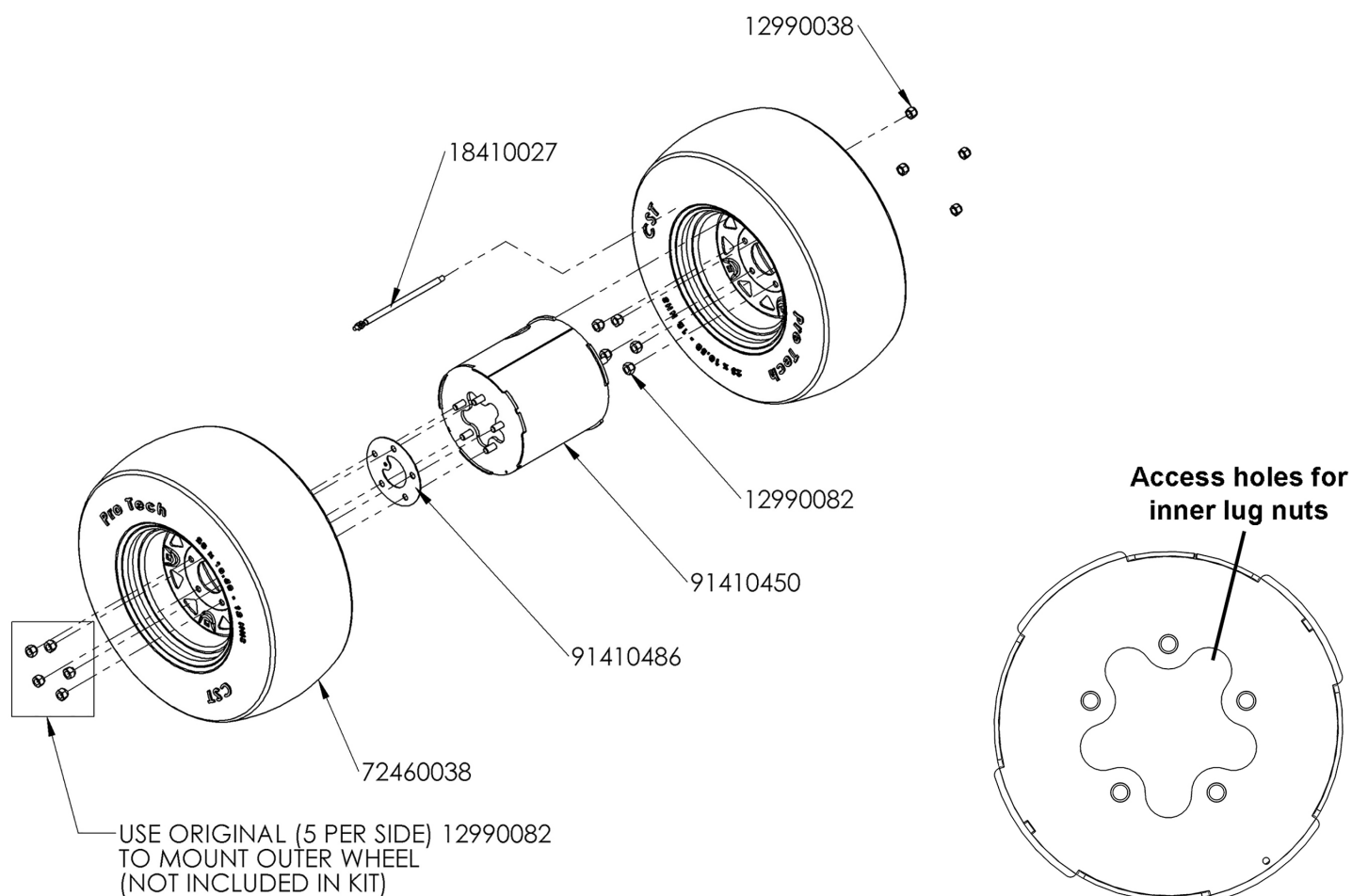

Installation Instructions - WSZK 72 Tweel Kit (95410048)

WHEEL HUB ASSEMBLY

1. Use a 13/16" socket to remove tire from mower, keep lug nuts (12990082) for reuse.
2. Use a flathead screwdriver to remove plastic cover from the wheel hub retaining nut.
3. Remove cotter pin.
4. Use a 1 7/16" Socket to remove castle nut. Screw nut on flush with axle.
5. Use a 6" 3 jaw gear or heavy duty hub puller to remove the hub from the wheel motor
6. Press 1/2" studs from hub.
7. Assemble bolt locking plate (91410473) to the hub. Refer to image for hardware orientation.
8. Use a 13/16" socket to tighten lug nuts (12990082).
9. Torque nuts to 80 ft-lbs.
10. Reinstall modified hub assembly onto the wheel motor.
11. Torque castle nut to 275-350 ft-lbs.
12. Reinstall cotter pin and plastic cap

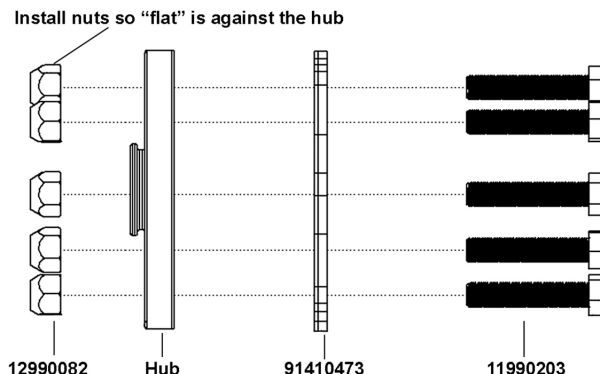

INSTALLING ONTO MOWER

1. Assemble and install dual tweel hub as instructed above.
2. Install inner tweel (72410098) onto mower with the interior side facing outwards.
3. Use a 3/4" socket with extension to attach wheel drum w/ studs (91410474) to dual tweel hub by reaching through the access holes of the drum. Use the provided nuts (12990092).
4. Torque to 80 ft-lbs.
5. Use 1/2" wrenches to remove rear anti scalp assemblies from outside rear corners of cutter deck.
6. Install outer tweel over the studs on the drum with interior side facing inwards.
7. Secure wheel to drum, re-using the original lug nuts (12990082).
8. Use a 13/16" socket and torque nuts to 80 ft-lbs.

After install, check lug nut torque every 100 hours to ensure the safety and performance of your machine.

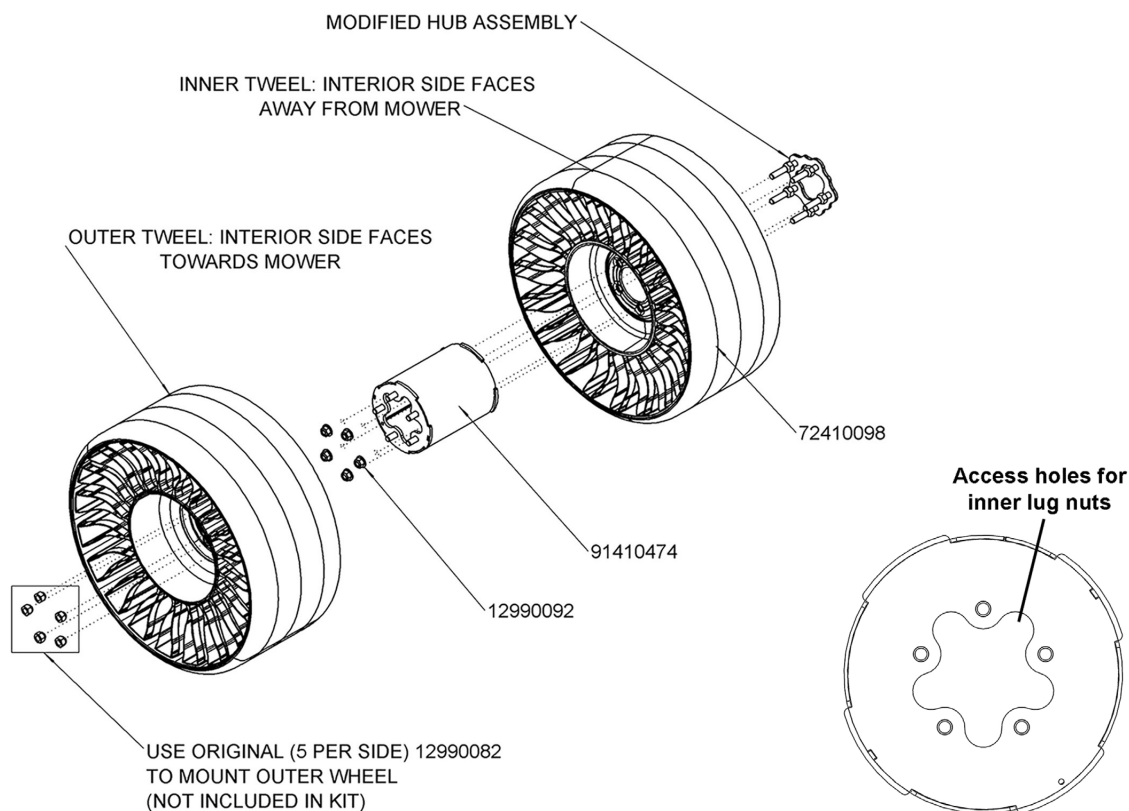

Installation Instructions - WZXT 72 Tweel Kit (95410050)

WHEEL HUB ASSEMBLY

1. Use a 13/16" socket to remove tire from mower, keep lug nuts (12990082) for reuse.
2. Use a flathead screwdriver to remove plastic cover from the wheel hub retaining nut.
3. Remove cotter pin.
4. Use a 1 7/16" Socket to remove castle nut. Screw nut on flush with axle.
5. Use a 6" 3 jaw gear or heavy duty hub puller to remove the hub from the wheel motor
6. Press 1/2 inch studs from hub
7. Assemble bolt locking plate (91410473) to the hub. Refer to image below for hardware orientation.
8. Use a 3/4" socket to tighten hex jam nuts (12990093).
9. Torque to 80 ft-lbs
10. Reinstall modified hub assembly onto the wheel motor.
11. Torque castle nut to 275-350 ft-lbs.
12. Reinstall cotter pin, reinstall plastic cap

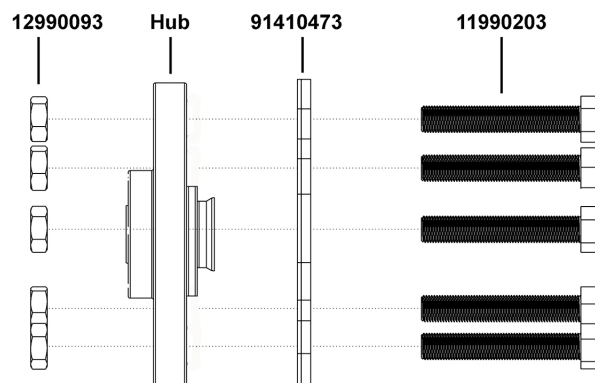

INSTALLING ONTO MOWER

1. Assemble and install dual tweel hub as instructed above.
2. Install spacer (91410484) onto hub
3. Install inner tweel (72410103) onto mower
4. Use a 3/4" socket with extension to attach wheel drum w/ studs (91410474) to dual tweel hub by reaching through the access holes of the drum. Use the provided nuts (12990092).
5. Torque to 80 ft-lbs.
6. Use 1/2" wrenches to remove rear anti scalp assemblies from outside rear corners of cutter deck.
7. Install outer tweel over the studs on the drum
8. Secure wheel to drum, re-using the original lug nuts (12990082).
9. Use a 13/16 socket and torque nuts to 80 ft-lbs.

After install, check lug nut torque every 100 hours to ensure the safety and performance of your machine.

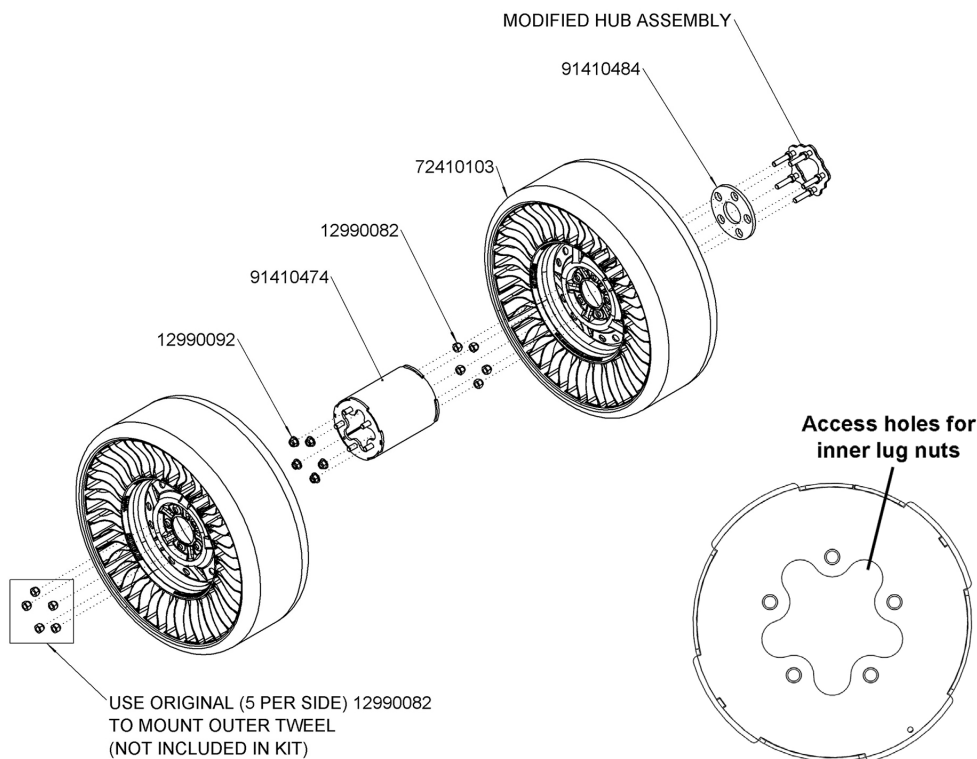

Installation Instructions - WZXT 72 Pneumatic Kit (95410051) and WSZK 72 Carlstar kit (95410067)

WHEEL HUB ASSEMBLY

1. Use a 13/16" socket to remove tire from mower, keep lug nuts (12990082) for reuse.
2. Use a flathead screwdriver to remove plastic cover from the wheel hub retaining nut.
3. Remove cotter pin.
4. Use a 1 7/16" Socket to remove castle nut. Screw nut on flush with axle.
5. Use a 6" 3 jaw gear or heavy duty hub puller to remove the hub from the wheel motor
6. Press 1/2 inch studs from hub
7. Assemble bolt locking plate (91410473) to the hub. Refer to image below for hardware orientation.
8. Use a 3/4" socket to tighten hex jam nuts (12990093).
9. Torque to 80 ft-lbs
10. Reinstall modified hub assembly onto the wheel motor.
11. Torque castle nut to 275-350 ft-lbs.
12. Reinstall cotter pin, reinstall plastic cap

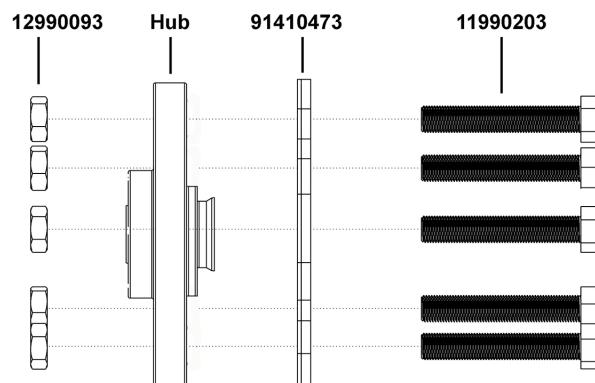

INSTALLING ONTO MOWER

1. Assemble and install dual wheel hub as instructed above.
2. Install spacer (91410484) onto hub
3. Install inner wheel assembly (72410101 for WZXT, 72410111 for WSZK) onto mower
4. Install Valve Extension (18410027) onto the inner wheel valve stem.
5. Install wheel drum w/ studs (91410485).
6. Use a 3/4" socket with extension to secure drum to hub with 5 nuts (12990092). Torque to 80 ft-lbs.
7. Push valve extension through hole in drum
8. Remove (1) nut from the valve extender and insert extender into the Valve Extension Plate (91410486). Install nut onto valve extension and use a 1/2" wrench and to tighten extension onto plate.
9. Install Valve Extension Plate onto the studs of the wheel spacer.
10. Use 1/2" wrenches to remove rear anti scalp assemblies from outside rear corners of cutter deck.
11. Install outer wheel assembly over the studs on the drum
12. Secure wheel to drum, re-using the original lug nuts (12990082).
13. Use a 13/16" socket and torque nuts to 80 ft-lbs.

After install, check lug nut torque every 100 hours to ensure the safety and performance of your machine.

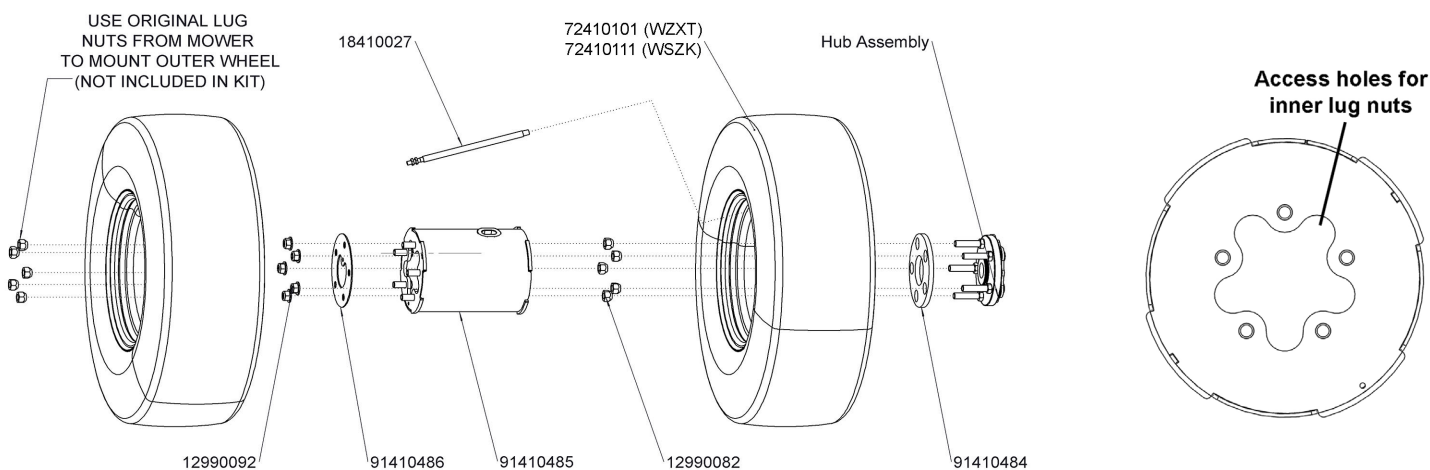

Installation Instructions - WSZK 52, Tweel Flip Kit 95410052

CAUTION

This kit is only necessary if you are installing a single set of tweels PN 72410098 (Michelin 54411) onto a ZK 52" unit.

If you have tweel PN 72410110 (Michelin 14365) no hub adjustments are necessary due to the different offset. You will need to install with spacers 91410498 instead.

1. Use a 13/16" socket to remove tire from mower, keep lug nuts (12990082) for reuse.
2. Use a flathead screwdriver to remove plastic cover from the wheel hub retaining nut.
3. Remove cotter pin.
4. Use a 1 7/16" socket to remove castle nut. Screw nut on flush with axle.
5. Use a 6" 3 jaw gear or heavy duty hub puller to remove the hub from the wheel motor.
6. Press 1/2" studs from hub
7. Assemble bolt locking plate (91410473) to the hub. Refer to image below for hardware orientation.
8. Use a 13/16" socket to tighten lug nuts (12990082).
9. Torque to 80 ft-lbs
10. Reinstall modified hub assembly onto the wheel motor.
11. Torque castle nut to 275-350 ft-lbs.
12. Reinstall cotter pin and plastic cap
13. Install tweel with interior side facing AWAY from mower.
14. Secure tweel to drum, re-using the original lug nuts (12990082).
15. Use a 13/16" socket and torque nuts to 80 ft-lbs.

After install, check lug nut torque every 100 hours to ensure the safety and performance of your machine.

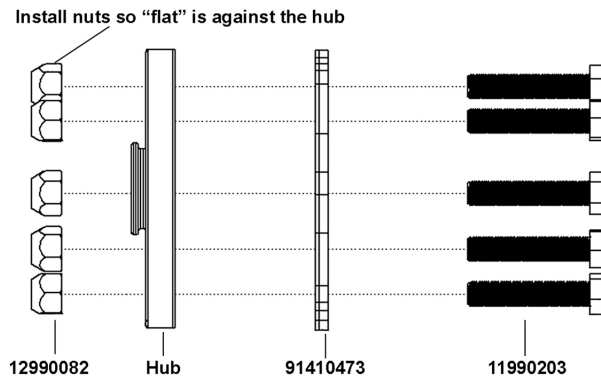



4600 Wedgewood Blvd Ste X

Frederick MD 21703-7167

www.wrightmfg.com