

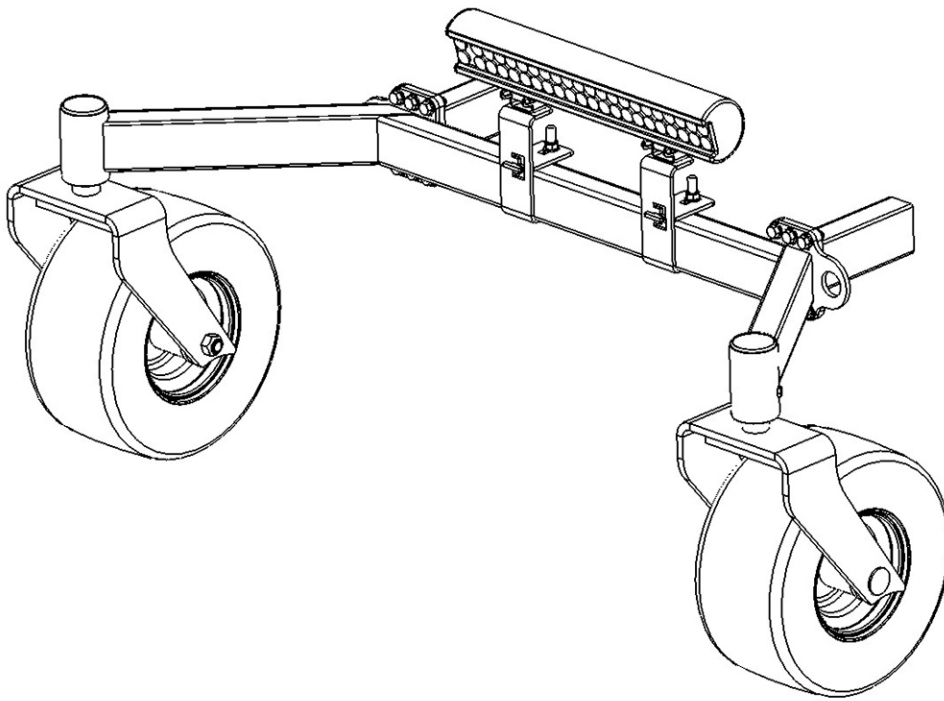

# Operator's Manual



## LIGHT BAR MOUNTING KIT

Brackets and Hardware Only. Light Not Included.

Revised July 2021

P/N 98490023

FAILURE TO FOLLOW SAFE OPERATING PRACTICES MAY RESULT IN SERIOUS INJURY OR DEATH.

Read this manual and other manuals that came with your mower before operating.

©1998-2019 Wright Manufacturing, Inc. All rights reserved. This material may not be reproduced or copied, in whole or part, without written permission from Wright Manufacturing, Inc. Grass Gobbler, Gobbler, Leaf Gobbler, Velke, Pro 1, X2, Stander, and Sentar are trademarks of Wright Manufacturing.

## Kit Contents

PN	DESCRIPTION	QTY.
11990183	BOLT, CARRIAGE, 3/8-16 x 4 Z5	2
12990065	NUT, FLANGE NYLOCK 3/8-16 Z5	2
93490046	WRIGHT LIGHT MOUNTING BRACKET	2
93490047	WRIGHT LIGHT BAR BOTTOM LOCK	2

## ⚠ ATTENTION

**Light bar not included. Compatible light bars will have the following features:**

- 1. Maximum length = 20"**
- 2. Adjustable mounting points**
- 3. Mounts using 5/16 (M8) bolt**

## Instructions

1. Attach Wright mounting brackets to caster using the bolt and nut included in the kit.

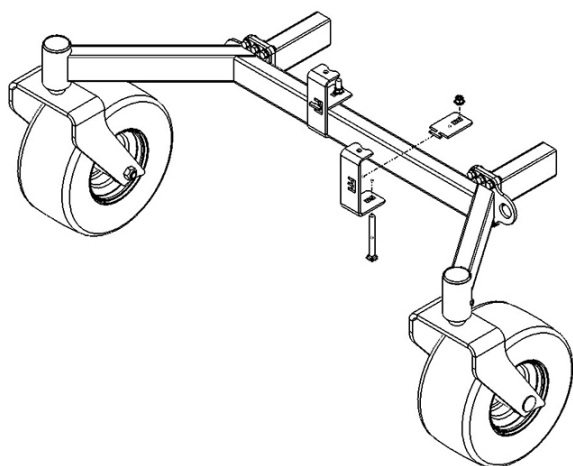

- a. Insert tab vertically, then rotate to be horizontal

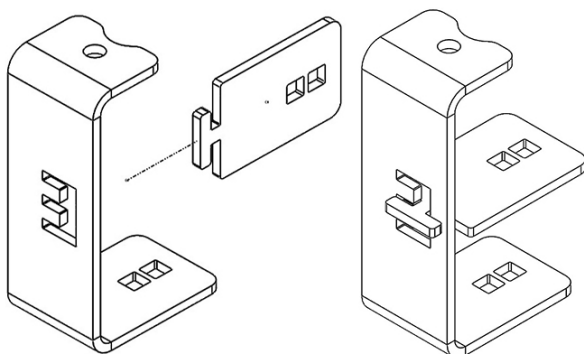

- b. Use the configuration appropriate for the tube size on the mower

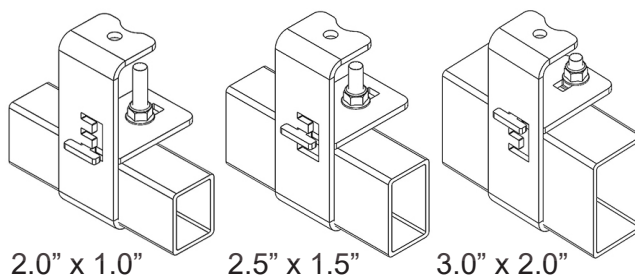

2. Assemble light bar according to manufacturer's instructions
3. Mount light using a bolt (not included) through the bottom of the light bar bracket.

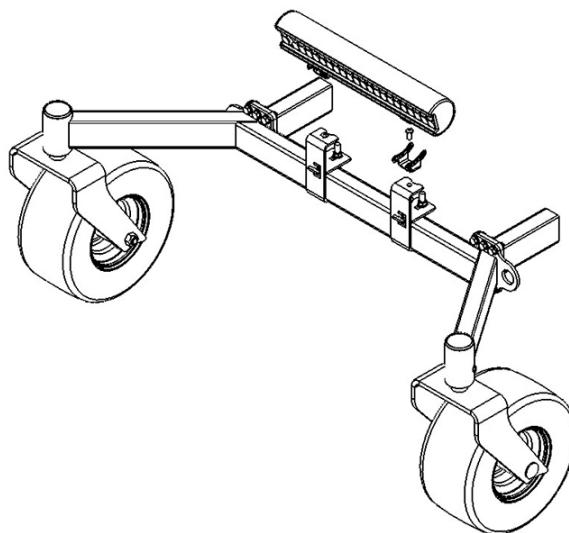

4. Adjust spacing of mounting brackets as needed.